



SOUTHWEST CORRIDOR LIGHT RAIL PROJECT

**Bonita to Bridgeport Route Evaluation
February 21, 2019**

Agenda

- **Presentation**
 - What is SW Corridor Light Rail?
 - Bonita to Bridgeport route options
 - Decision process
- **Station characteristics**

SOUTHWEST CORRIDOR

November 2018 preferred alternative.
Conceptual rendering subject to change.

- Alignment
- ⋯ Further study
- Existing light rail
- Stations
- Ⓟ Stations with Park & Ride

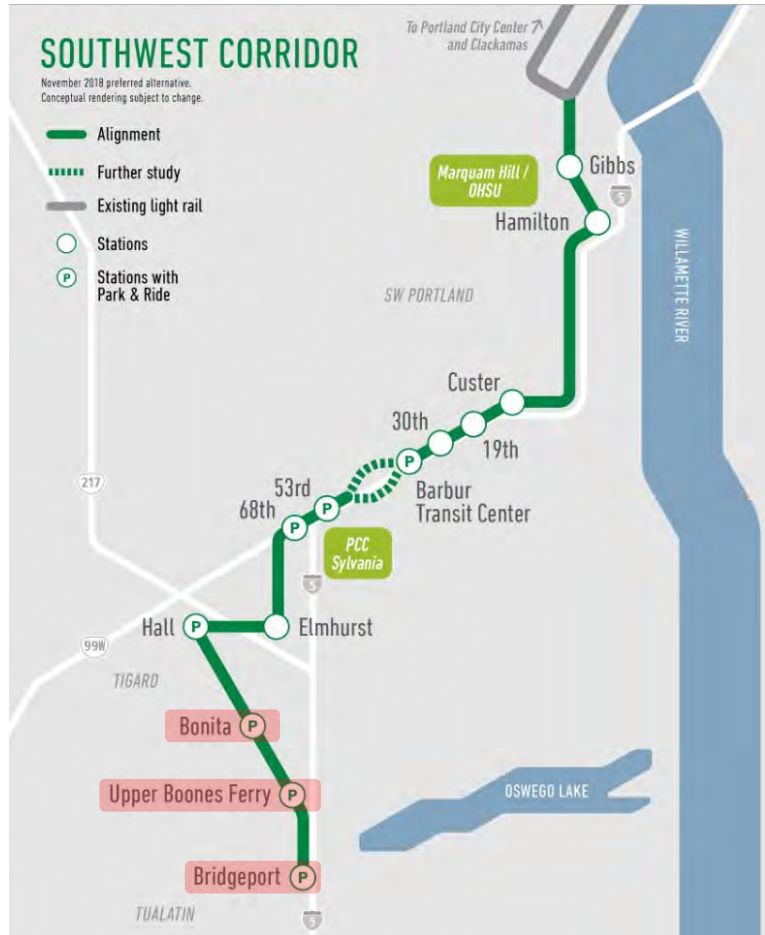

Project Benefits

- 30-minute congestion-proof trip from Bridgeport to Portland
- Serves a two-way commute
- Jobs in Tigard, Tualatin
- Park & Ride and bus connections at Bridgeport station

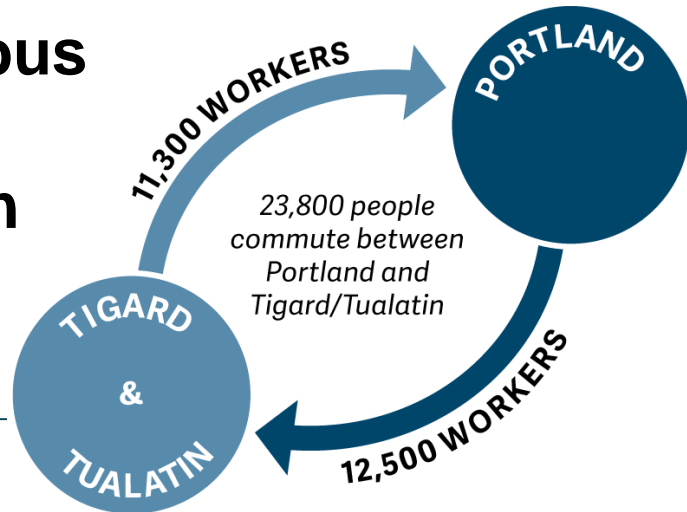

Project Benefits

43,000 rides on the line on an average weekday in 2035



1 in 5 commuters on MAX going southbound from downtown during 2035 PM rush hour

Partners



Decision-making

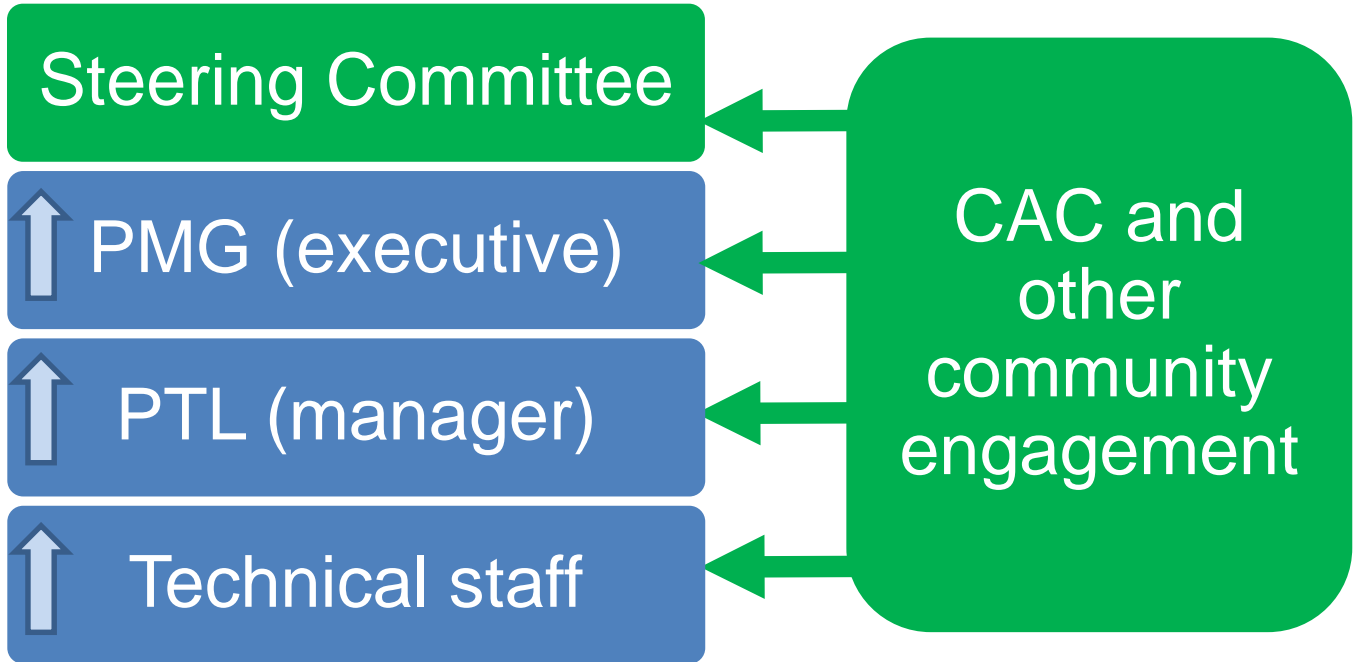

TIMELINE

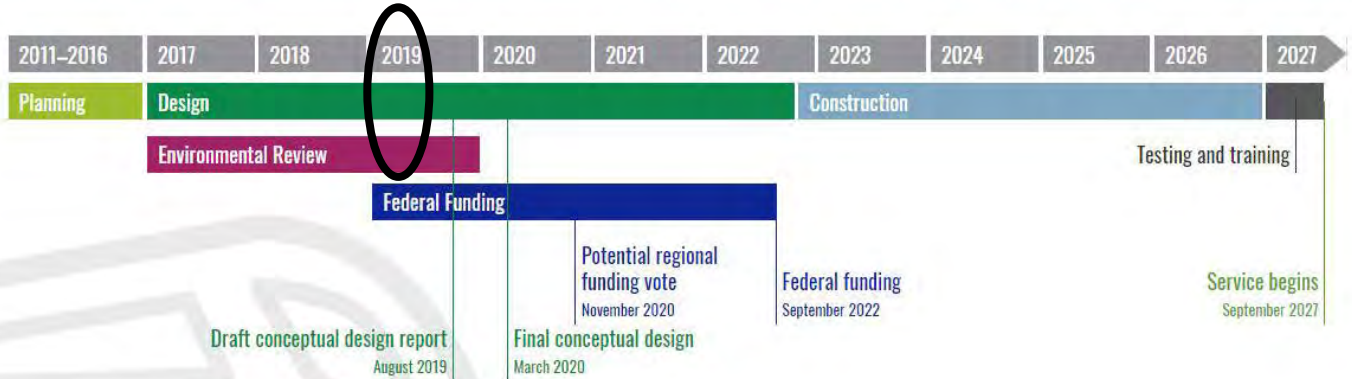

Bonita to Bridgeport

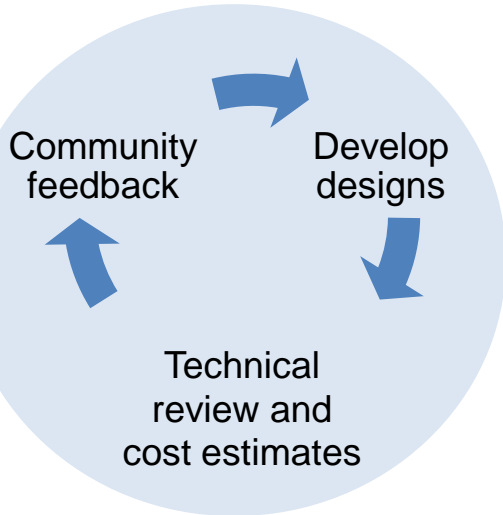

Early 2019

- Exploring options; no decisions have been made
- More public meetings, data for comparing options
- Route decision this spring; current target May
- (Ongoing design work continues for years)

Locally Preferred Alternative (LPA) route between Bonita and Bridgeport

- Draft Environmental Impact Statement (DEIS) identified significant **traffic issues at Upper Boones Ferry Rd** at-grade crossing
- DEIS received hundreds of comments advocating against **Village Inn displacement at Bridgeport station**

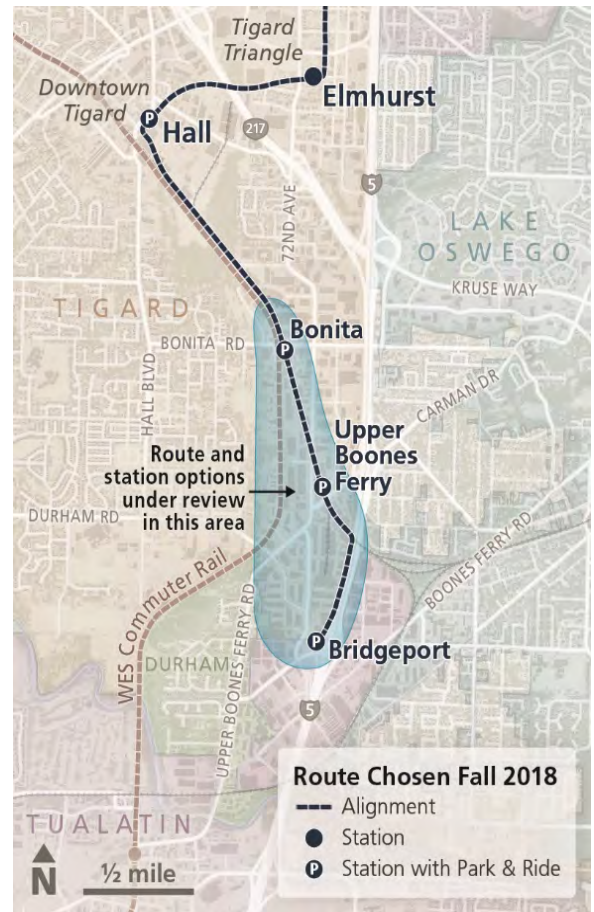

LPA route

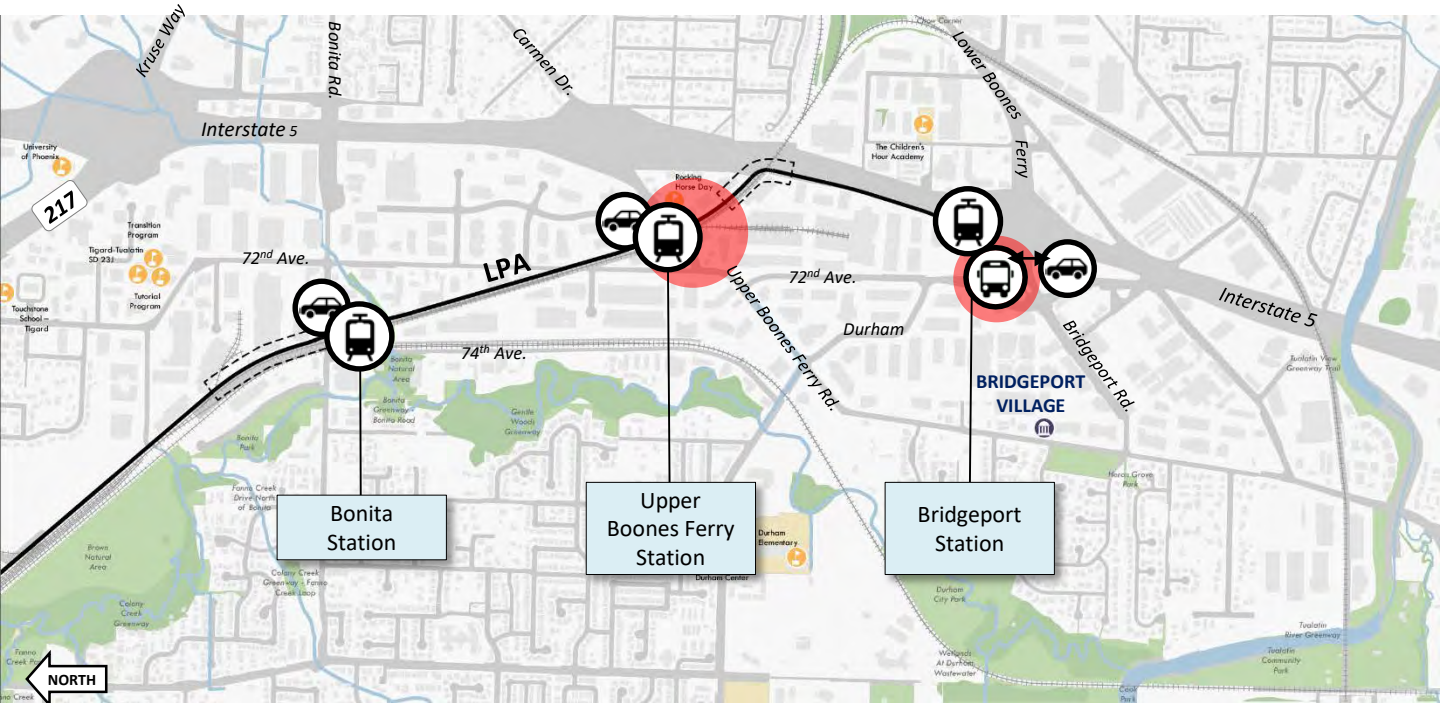

Exploration of Options

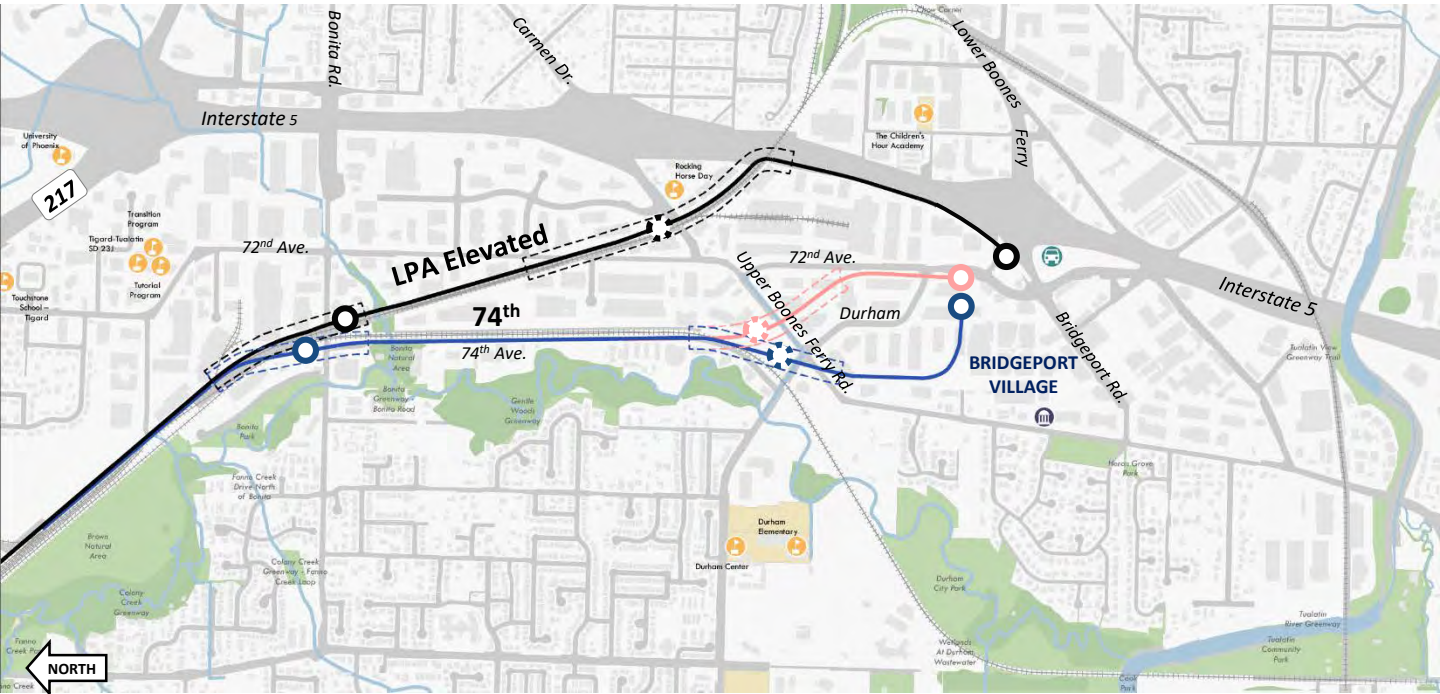

Exploration of Options

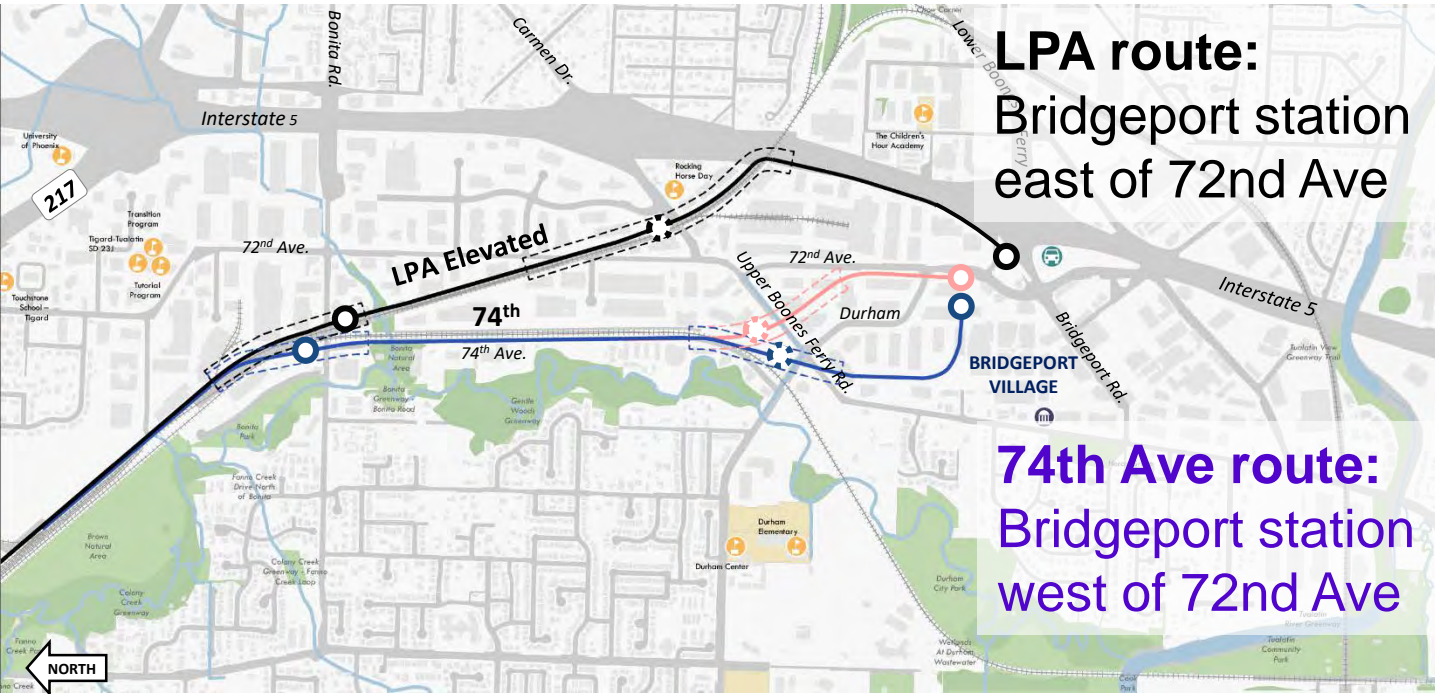

LPA route:
Bridgeport station
east of 72nd Ave

74th Ave route:
Bridgeport station
west of 72nd Ave

Elevated LPA route concept

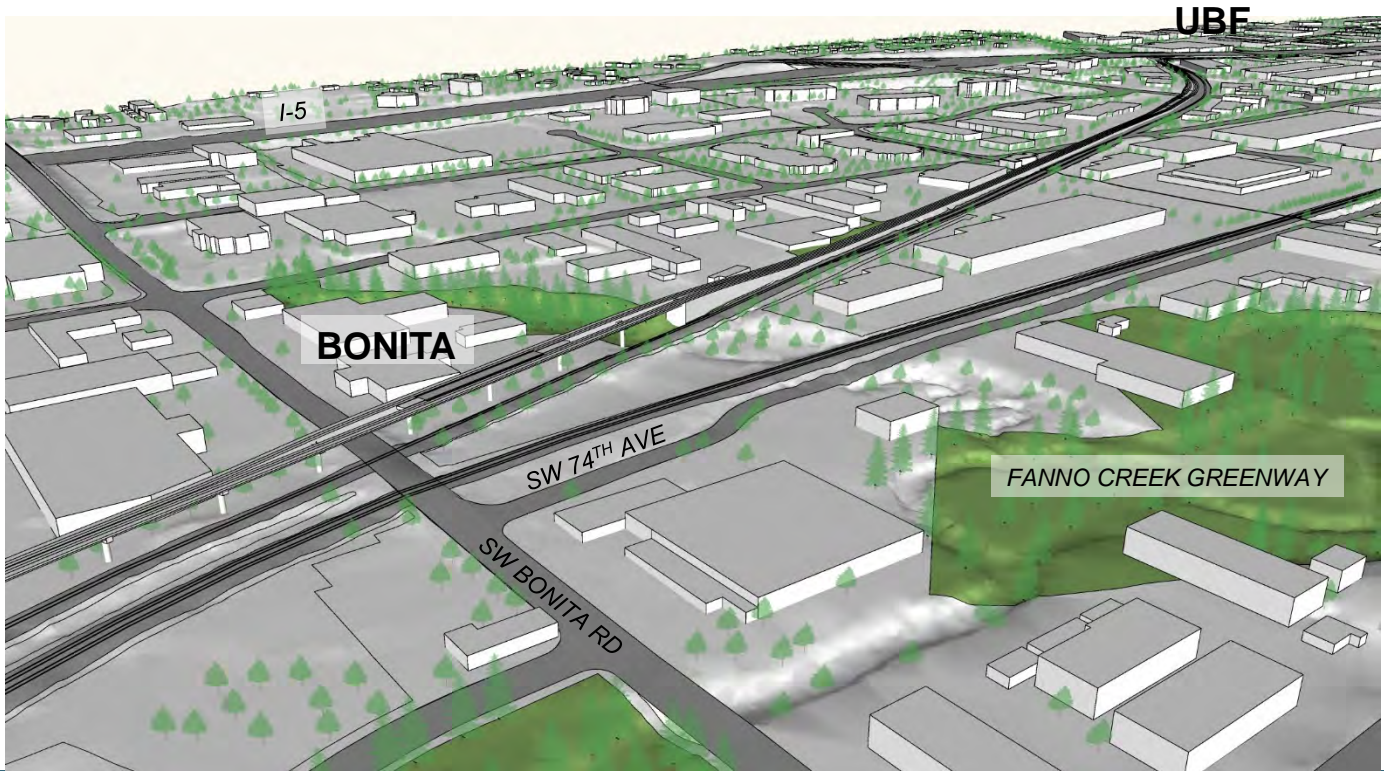

LPA route: Bonita



**ELEVATED
BONITA
STATION
AREA**

LPA route: Upper Boones



LPA route: precedents



Guideway Navigating Infrastructure



Slipping into the Existing Context



Via LPA Route: Bridgeport Station east of 72nd Ave 2018 DEIS Layout



- Station adjacent to bus hub
- Park & Ride south of Bridgeport Rd, with pedestrian bridge
- Impact to Village Inn

- A MAX Station
- B Bus Hub
- C Park & Ride (P&R)
- D Mobility Plaza
- E Pedestrian Bridge
- F Transit Oriented Development (TOD)
- Signalized Intersection
- Impact or Concern

Via LPA Route: Bridgeport Station east of 72nd Ave 2019 Concept B



- Station adjacent to bus hub
- Park & Ride south of Bridgeport Rd, with pedestrian bridge
- Impact to retail
- Potential bus/auto traffic conflicts
- Potential TOD opportunities

A MAX Station **C** Park & Ride (P&R) **E** Pedestrian Bridge **O** Signalized Intersection
B Bus Hub **D** Mobility Plaza **F** Transit Oriented Development (TOD)

Via LPA Route: Bridgeport Station east of 72nd Ave

2019 Concept C



- Station adjacent to bus hub and Park & Ride
- Multiple retail impacts
- Potential TOD opportunities

A MAX Station **C** Park & Ride (P&R) **E** Pedestrian Bridge **○** Signalized Intersection
B Bus Hub **D** Mobility Plaza **F** Transit Oriented Development (TOD)



Bonita to Bridgeport

74th Ave route concept



Adjusting 74th Ave

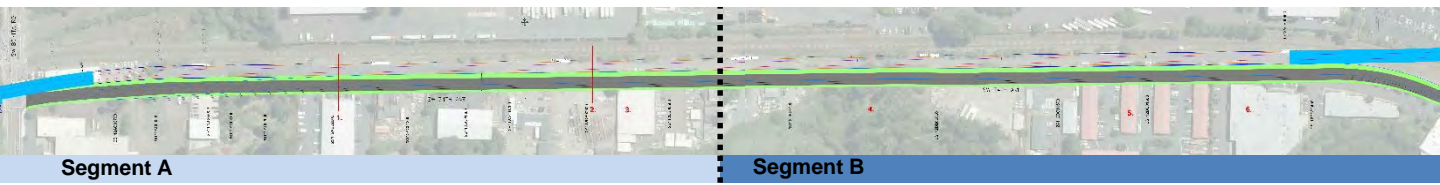

Segment A

Segment B

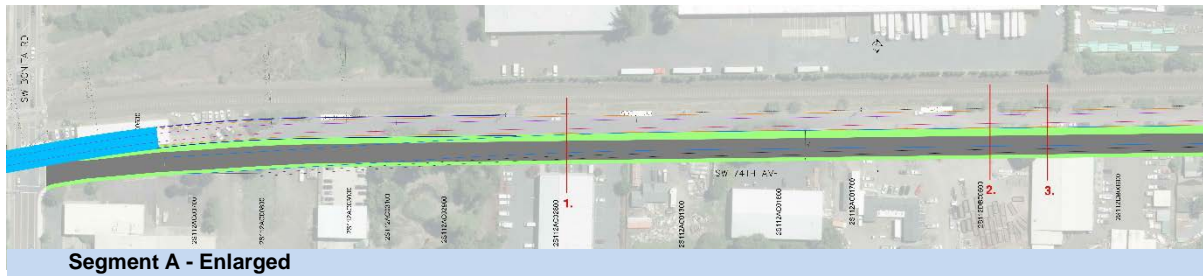

Segment A - Enlarged

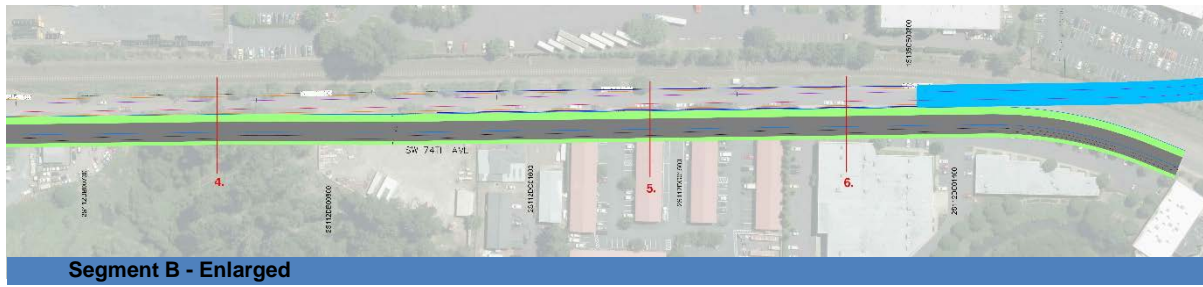

Segment B - Enlarged

74th Ave – example widths

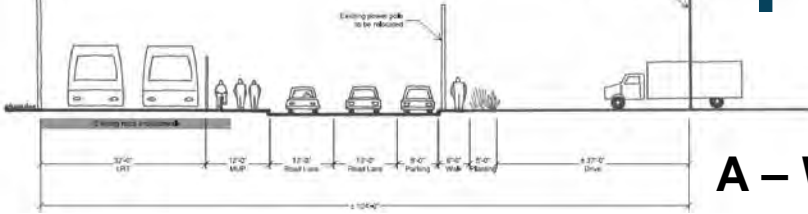

A – With complete amenities

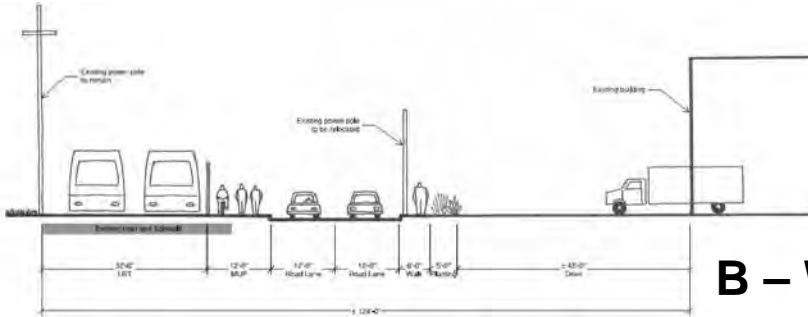

B – Without on-street parking

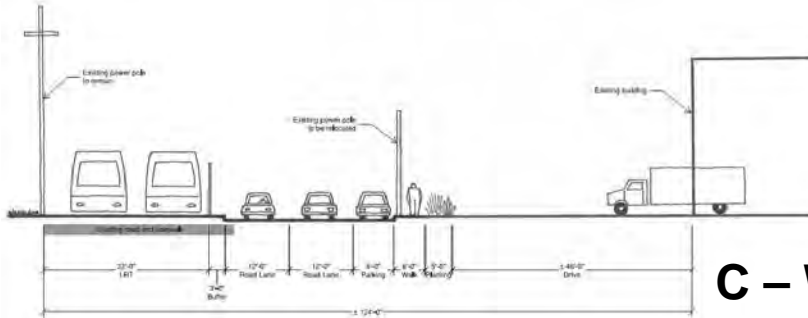

C – Without multi use path

74th Ave route: Bonita



**ELEVATED
BONITA
STATION
AREA**

74th Ave route: Upper Boones



ELEVATED
UBF
STATION
AREA

74th Ave route: precedents



Guideway Transition to Structure



Station Bridging Roadway



Station next to Roadway

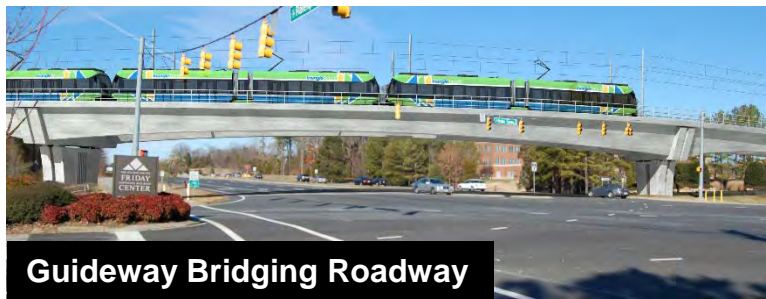

Guideway Bridging Roadway

74th Avenue Route: Bridgeport Station West of 72nd Ave 2019 Concept E



- Station west of 72nd
- Bus hub, Park & Ride, and Quick Drop east of 72nd
- Pedestrian crossing improvements
- Some impacts to Office/Flex Space

A MAX Station **C** Park & Ride (P&R) **E** Pedestrian Bridge **O** Signalized Intersection
B Bus Hub **D** Mobility Plaza **F** Transit Oriented Development (TOD)



Bonita to Bridgeport

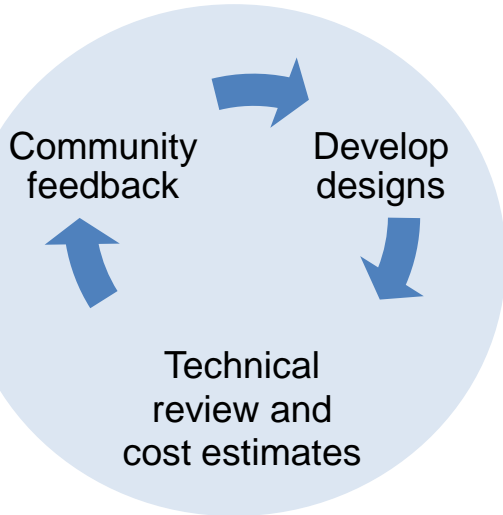

Early 2019

- Exploring options; no decisions have been made
- More public meetings, data for comparing options
- Route decision this spring; current target May
- (Ongoing design work continues for years)

Data for comparing options

	LPA Elevated	74th Ave	Refinements TBD?
Light rail travel time			
Traffic impacts			
Construction costs			
Displacements (businesses, employees)			
Natural resource impacts			
Walksheds			
Opportunities			

Next steps

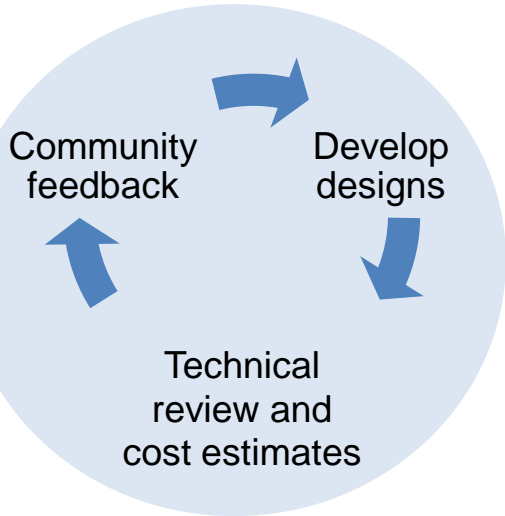

- Data for comparing options
- Next meeting:
trimet.org/swcorridor
- Station characteristics

Early 2019

Station characteristics

Commuter or Community



TriMet Lincoln St Station



Calgary Tuscany Transit Center



Calgary Tuscany Transit Center



Sound Transit Othello Station



Gresham Hatfield Station



Denver Commuter Station

Precedents: Commuter

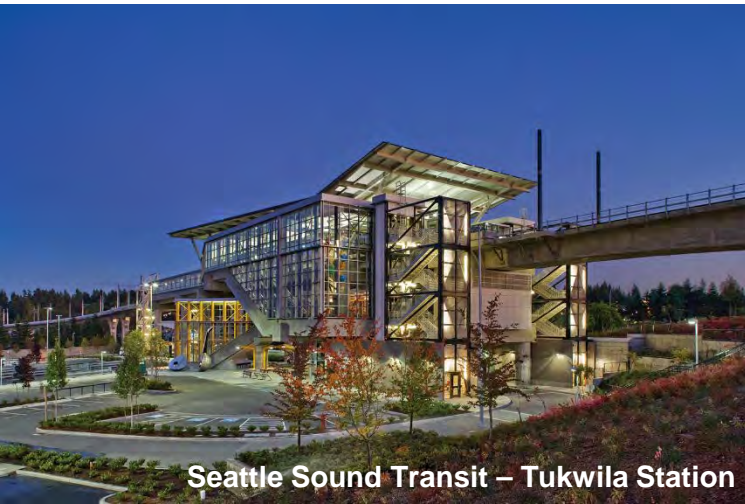

Seattle Sound Transit – Tukwila Station



TriMet – Sunset Transit Center

Precedents: Community



TriMet Lincoln St



Gold Coast, Australia

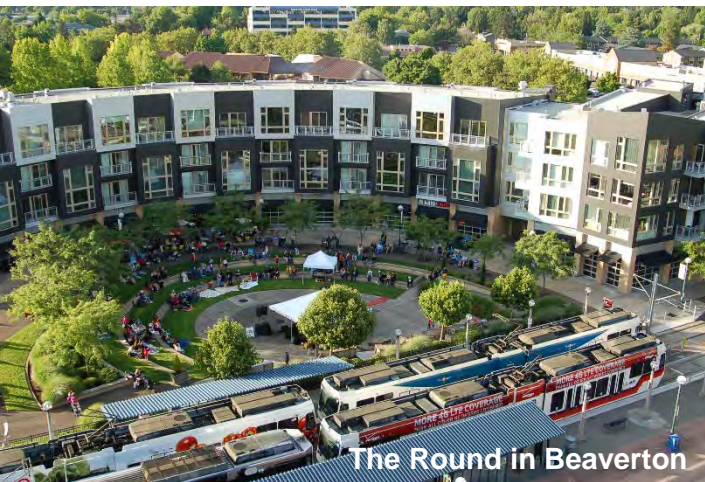

The Round in Beaverton



Town Station in Strasbourg, France

Place-making and People

Orenco Station Plaza –
A Multi-Purpose Community Space



As TOD Outdoor Expansion



As an Event Space

